



Kwalu Features

Product Dimensions and Specs

Overall 21W 20.5D 30H
Wt. 82 lbs

Product Statement of Line Images



Camelot Mobile Cabinet, 3
Drawers, Linen Top
Model: CABS30HCCT
21W 20.5D 30H



Camelot Mobile Cabinet, 1
Drawer, 1 Door, Left-Hinged,
Linen Top
Model: CABS11HCCTL
21W 20.5D 30H



Camelot Mobile Cabinet, 3
Drawers, Kwalu Fusion Top
Model: CABS30HCFT
21W 20.5D 29.75H



Camelot Mobile Cabinet, 1
Drawer, 1 Door, Right-Hinged,
Linen Top
Model: CABS11HCCTR
21W 20.5D 30H



Camelot Mobile Cabinet, 1
Drawer, 1 Door, Left-Hinged,
Kwalu Fusion Top
Model: CABS11HCFTL
21W 20.5D 29.75H



Camelot Mobile Cabinet, 1
Drawer, 1 Door, Right-Hinged,
Kwalu Fusion Top
Model: CABS11HCFTTR
21W 20.5D 29.75H

Product Features



Durable Finish

Kwalu's proprietary finish doesn't have any of the drawbacks of wood. The finish is moisture impervious, easy to clean and maintenance-free.

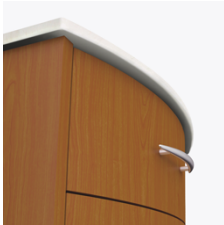

Curved Front

The graceful curved front is a signature Camelot feature.



Corian® Top

Available with a 1" thick Corian® top in Linen finish.



Bumper Protection

Bumper protection keeps unit in pristine condition and protects unit from bumps and scuffs.

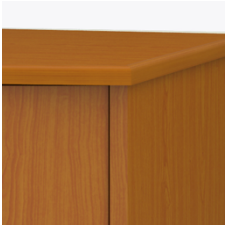

Optional Kwalu Top

Available with a ¾" top made of Kwalu's proprietary material.

[Learn More >](#)

Product Finishes

Casegood Finish



Sugar Maple Weathered Teak Vintage Teak Light Walnut Patagonian Cherry Medium Cherry



English Chestnut Northern Walnut American Walnut Golden Ebony Silver Ash African Mahogany



Espresso Natural Mahogany Midnight Oak

Product Environmental Certifications

