

## Kwalu Features

### Kwalu Fusion

- Kwalu's proprietary polymer material
- Non-coated
- Routed edge seam

### Moisture Impervious

- Our Kwalu material is smooth, non-porous, and liquid impervious

### Proprietary Maintenance-Free Finish

- Chemical, impact, ink, and scratch resistant
- 100% free of short-lived catalytic lacquers, polyurethane varnishes and delicate wood veneers
- Look of wood's enduring beauty, without undertaking its costly setbacks

### Easy to Clean

- Withstands rigorous cleaning regime
- 100% bleach cleanable
- Provide long term cleanability
- Survives All EPA's Cleaning-Disinfectant Agents
- Survives Clorox's Healthcare Portfolio of Cleaning-Disinfectant Products

### 24/7 10-Year Performance Warranty on Kwalu-made Panels

- Kwalu's warranty is to term, not pro-rated
- Guaranteeing both the furniture construction and finish
- For full details of warranty offered, including any bought-out items, please refer to the Terms and Conditions of Sale <https://www.kwalu.com/sales-terms-conditions/>

### Eco-friendly

- LEED credits available for "Material + Resources" and "Indoor Environmental Air Quality"
- Made in North America
- CARB Compliant

## New York Collection Features

### Tops

- Edge Type: Waterfall profile
- Edge Banding Thickness: 3/8"
- Top Overhang: - Sides: 1/8" - Front: 1/8" - Back: 1/16"
- Corner Radius: 1/2"
- Optional 1" thick solid surface top

### Drawers

- Drawer Style: Full overlay
- Matching vertical grain on all drawers
- Drawer Slide: 100lb. nickel plated, side mounted, ball bearing removable slides
- Drawer Box Sides and Back: 3/4" laminated board
- Drawer Bottom: 1/4" laminated board
- Drawer construction: 3- piece construction; dowel and mechanical fasteners
- Drawer Pulls: ADA Compliant pulls available
- Edge Banding Thickness: 1/16"

### Back Construction

- 3/4" Back panel

### Jointing System

- Dowel and mechanical fasteners

### Venting

- Venting on back of bedside cabinet with three drawers

### Casters

- 3" twin-wheel locking casters on front, 3" twin-wheel non-locking casters on rear

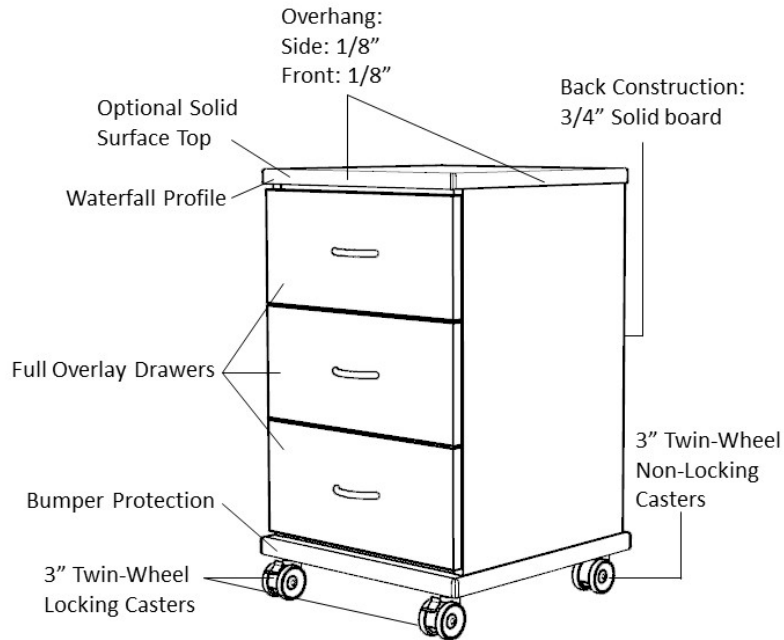

## Product Dimensions and Specs

Overall 19W 19D 30H

Wt. 56 lbs

Product Statement of Line Images



New York Mobile Cabinet, 3 Drawers, Linen Top  
Moasdfadel: NYBS30CT  
19W 19D 30H



New York Mobile Cabinet, 3 Drawers, Kwalu Fusion Top  
Moasdfadel: NYBS30FT  
19W 19D 29.75H



New York Mobile Cabinet, 3 Drawer, Fusion Top, Secondary Floating Linen Top with Spillproof Edge  
Moasdfadel: NYBS30FT2CT  
19W 19D 38H



New York Mobile Cabinet, 3 Drawer, Fusion Top, Secondary Floating Fusion Top  
Moasdfadel: NYBS30FT2FT  
19W 19D 37.75H

Product Features



Nightingale Award

Kwalu's GetWell Patient Room was awarded a Nightingale Innovation Award for Surfacing Material.



Durable Finish

Kwalu's proprietary finish doesn't have any of the drawbacks of wood. The finish is moisture impervious, easy to clean and maintenance-free.

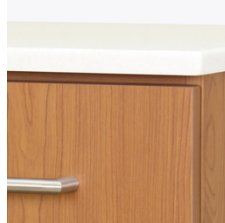

Corian® Top

Available with a 1" thick Corian® top in Linen finish.



Bumper Protection

Bumper protection keeps unit in pristine condition and protects unit from bumps and scuffs.



Optional Drawer Liner

Choose specially crafted optional removable and cleanable drawer liners.

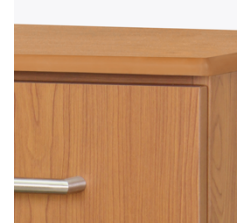

Optional Kwalu Top

Available with a ¾" top made of Kwalu's proprietary material.



Optional Secondary Floating Top

Secondary Floating Top available in either Corian® Linen with spillproof edge, or Kwalu Fusion.

Product Finishes

Casegood Finish



Wood Ash  
(Fusion)

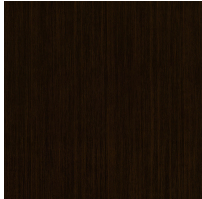

Midnight Oak  
(Fusion)



Espresso  
(Fusion)



Natural  
Mahogany  
(Fusion)



African  
Mahogany  
(Fusion)

Product Environmental Certifications

